



š } } u } oo P %œ } (•• } œ V } œ š } v š œ %œ } (•• } ž } μ œ μ }
Æ %œ v } Iv } Á o P } (Z μ v v š Z } μ P Z š U u } Ÿ } v U v } Z Á } } œ] • œ o Á v š š } v Ç } œ

x @Q' —Fb†à y.¿)–ñ 'f(0

& μ o š Ç W œ } . o •

œ X ' } } Á] v] • } P v] Ÿ Á %œ • Ç Z } o } P] • š Á Z } } v μ š • œ • œ Z] v œ • œ o š œ š P œ u } } œ }
Æ %œ œ] u v š o W • Ç Z } o } P] • š Á Z } } v μ š • œ • œ Z] v œ • œ o š œ š P œ u } } œ }
œ } u ^ ž œ œ W Z X P œ (œ } u & o } œ] ^ š š h v] Á œ •] š Ç X

D œ l E } o œ U W Z X X U œ x v } } d W œ } (Á • } œ œ • } μ v • o] v P W • Ç Z } o } P] • š (} œ š Z s š œ }
} μ š %œ Ÿ v š o] v]] v & } œ š } } Á œ U D v • %œ] o] •] v š Z D v š o l Z Á } } œ œ } , W • Ç Z Z } r
š Z œ %œ Ç š dh] v E } œ š Z • š œ v D œ Ç o v v Z • v š Z] v P š d } Á • } v h v } œ } œ œ } š Ç
d Z h v] Á œ •] š Ç X

: } • Z } • } U > ' W U E U D U : } μ v] š W œ } (œ • š } œ v œ v P Á œ Ç v] W K o] v]] v Á Z } Á }
μ o š • U } μ %œ • U • Á o o • (u] o] • X , ' œ μ Ç • D œ u œ o } %œ] Á] v š } μ œ v } μ o š } U } P , œ (} œ } μ v
] Ÿ } v š } Z] • o] v] o] P œ } μ v U : } •] • o • } D W Z P] • š œ W œ ^ μ } %œ Á] } Á œ Z } Z
D • š } œ] v o] v] o D v š o , o š Z } μ v • o] v P (œ } u E } œ š Z Á • š œ v h v] Á œ •] š Ç v œ Á] Á
z } œ l [i ò U]] š Z X u v š o Z o š Z Á } Ç] v P μ • š Z š] • v œ œ Ÿ š Á Z] • P Z] v œ š v } μ v } œ } Ÿ } Á
œ š š } • š œ š o œ P œ v Á œ • Ÿ } v } μ š u v š o Z o š Z Á œ v ••] v } v } š Ç } • ž] o] v }
• %œ] o o Ç] v š Z œ š • Á X u œ μ v] š Ç X P] v • š } %œ •• } } v X } u •

< μ v š o Ç œ] Á [• Z] • P œ • š (œ } u d } Á • } v h v } Á œ] u] š Ç o W • Ç Z } o } P Ç [%œ] P œ œ u X] D œ œ D š P œ }
o v o Ç } • U š u] v] v P] v W • Ç Z } o } P Ç v μ Ÿ } v U • š Ÿ • Ÿ o u } o] v } μ } o u œ] œ Ç •• Ç
%œ } X } œ • v š Á } œ] Ÿ • Ÿ r i μ v š (μ o š Ç š Z] v P Z Á á } œ l š p Ÿ r

^ X œ] P Z μ • Z U W Z X X] • v •• }] š %œ } (•• } œ] v š Z d
] v š } œ } (š Z Z μ œ o œ Á o } %œ u v š] v ^ Z } } o W • Ç Z } o } P Ç ~ Z ^ • > š d š Z V X Z X R œ }
• Z } } o %œ • Ç Z } o } P Ç v v X ^ X] v • Z } } Ÿ } %œ • Ç %œ } Ç } Z Ç X } P Ç o • } œ v D X ^ X } P œ P U } μ
• š v μ • } μ v • o] v P U v Á } Ÿ } v o Á o μ Ÿ } v (œ } u • š œ } o] v h v] Á œ •] š Ç X ((} œ š o }
u u œ š d Z h v] Á œ •] š Ç } (o u v œ œ Ç h v] Á œ •] š Ç X (} œ Á } œ l] v P P v] • μ v U
E } œ š Z œ } o] v v E Á X ,] • E Ÿ } v o o Ç œ Ÿ . ^ Z } } o W • Ç Z } o } P] • š œ Ÿ . >] v •• Z } %œ }
%œ • Ç Z } o } P Ç] v D œ Ç o v X } o o Ÿ Á o Ç U œ X Z μ • Z Z • Á } œ l] v œ μ œ o u œ Z } o š Z œ o š Z
œ } o Ç (} μ • } v œ μ œ o] • %œ] Ÿ • X œ X Z μ • Z o • } Á } œ l •] v %œ] Á š %œ Ÿ X

Z œ %œ • W l l Á Á X š } Á • } v X μ l o l %œ š u v š • l %œ • Ç Z } o } P Ç l

Towson University offers students the opportunity to obtain a bachelor's degree (B.S.) in Psychology without ever leaving Harford County! Students who complete Harford Community College's Associate of Arts (A.A.) in Psychology will be eligible to transfer to the Towson University in Northeastern Maryland facility on the Harford Community College campus to earn a bachelor's degree.



A cumulative GPA of 2.0
 A grade of C (2.0) or higher in all required and/or major courses taken at HCC including the following prerequisites:

English 101—English Composition	PSY 101—General Psychology
Math 216—Introduction to Statistics	PSY 214—Human Development Across the Life Span
PSY 204—Abnormal Psychology	PSY 209—Social Psychology

Behavioral Statistics (4)
 Biological Psychology (3)
 Introduction to Family Studies (3) *
 Exploring Addiction (3) *
 Parent-Child Relationships (3) *
 Family Law (3)*

F

* choose 3 Of 4

Research Methods (4)
 Ethics in Human Services (3)
 Relationships (3)
 Family Theories (3)
 See Advisor for options (3)

Dept. Choice (3)
 Dept. Choice (3)
 Dept. Choice (3)
 Dept. Choice (3)
 Case Management (3)

The Psychology of Gender (3)
 Dept. Choice (3)
 Dept. Choice (3)
 Contemporary Trends in the Family (3)
 (3) ____
 See Advisor for options (3)

Sequence can be individualized to meet the needs of each student. Electives can be filled with courses from Communications, Sociology/Criminal Justice, and other electives offered from TU at TUNE or online.

For further information about the [psychology/](http://www.towson.edu/psychology/) to view the www.towson.edu/, please visit the Psychology home page at www.towson.edu/

TU in Northeastern Maryland
 510 Thomas Run Road • Bel Air, MD 21015
 410-704-TUNE (8863) • TUNEMD@towson.edu

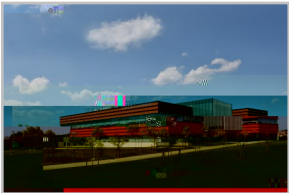

Director, Psychology Program
 TU in Northeastern Maryland
 410-704-3202 • kgoodwin@towson.edu

Cecil College: Associate of Arts (A.A.) in Psychology
Towson University: Bachelor's Degree (B.S.) in Psychology

Towson University offers students the opportunity to obtain a bachelor's degree (B.S.) in Psychology without ever leaving northeastern Maryland! Students who complete Cecil College's Associate of Arts (A.A.) in Psychology will be eligible to transfer to the Towson University in Northeastern Maryland facility on the Harford Community College campus to earn a bachelor's degree.

NOTE

-
- Established partnerships with local community colleges provide a seamless transfer and assure maximum transfer credit.
 - All programs are Maryland Higher Education Commission (MHEC) approved and, if applicable, accredited by their specific professional organization.
 - The same high caliber instructors teaching on main campus also teach courses at Towson University in Northeastern Maryland (TUNE).
 - Students receive a bachelor's degree awarded by Towson University. The programs at TUNE are identical to those on main campus.

- Fulltime TUNE students save more than \$1,500 per year on fees as compared to students on the main campus. Tuition amounts are the same at both locations.
- Parking is free and convenient.
- TUNE students save on room and board, which costs approximately \$11,000 per academic year on the main campus.
- Students are eligible for the same Financial Aid packages (grants, scholarship, loans, etc.) that are awarded to main campus students. In order to be considered, students must submit the FAFSA by the posted deadline.
- Student employment opportunities are available on-site.

- Program advisors and admissions representatives hold regular office hours on-site.



